



# QUILLIAM

Nero Court  
Brentford

- Hot Water and heating included
- One Double Bedroom Apartment
- Lovely Water Views
- Recently Fitted Kitchen
- Modern White Bathroom
- Allocated Parking Space
- Communal Riverside Grounds
- Unfurnished
- Close to High Street
- 24hr Security and Convenience Store

**£1,600 PCM**





## Property Description

Brentford Dock: A light bright and spacious one double bedroom apartment with allocated parking on this popular marina development. This property has the added benefit of stunning water views and has recently been refurbished to include a well appointed kitchen, bathroom and carpet. Hot Water and heating included in the rent.





# Accommodation



# Property Information



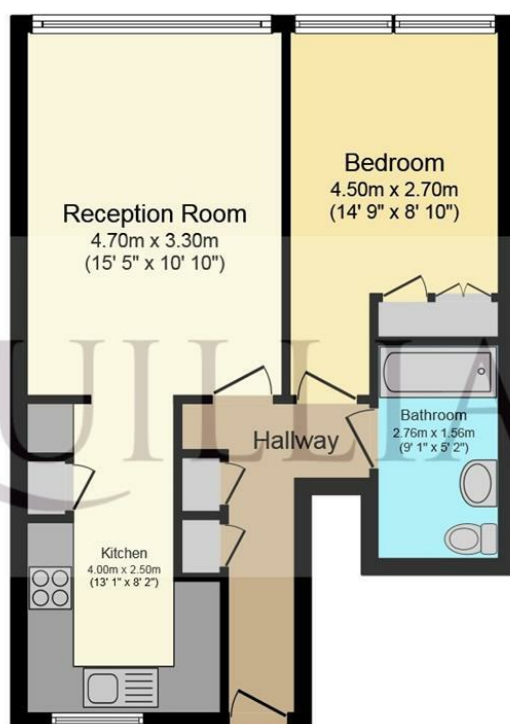

## Floor Plan

Floor area 45.2 sq.m. (486 sq.ft.) approx

Total floor area 45.2 sq.m. (486 sq.ft.) approx

This Floor Plan is for illustration purposes only and may not be representative of the property. The position and size of doors, windows and other features are approximate. Unauthorized reproduction prohibited. © PropertyBOX



Energy Efficiency Rating		
	Current	Potential
Very energy efficient - lower running costs		
(92 plus) <b>A</b>		
(81-91) <b>B</b>	81	82
(69-80) <b>C</b>		
(55-68) <b>D</b>		
(39-54) <b>E</b>		
(21-38) <b>F</b>		
(1-20) <b>G</b>		
Not energy efficient - higher running costs		
<b>England &amp; Wales</b>	EU Directive 2002/91/EC	



206 High Street  
Brentford  
TW8 8AH

020 8847 4737  
info@quilliam.co.uk  
<https://www.quilliam.co.uk>

Agents Note: Whilst every care has been taken to prepare these particulars, they are for guidance purposes only. All measurements are approximate and are for general guidance purposes only and whilst every care has been taken to ensure their accuracy, they should not be relied upon and potential buyers/tenants are advised to recheck the measurements